

Quick Start Guide

Illustra Pro 2MP Indoor Micro-Dome



8200-1631-06_B0

1- In the box

- 5 plastic 25mm screw anchors
- 4 Phillips pan head tapered screws 3mm x 25mm
- 3 Phillips pan head tapered screws 3mm x 10mm
- 3 Hex stand-offs M2.5 x 0.45P x 17mm
- 3 Phillips flat head machine screws M2.5 x 0.45P x 4mm
- 1 Deco adhesive backed trim ring
- 1 Front adhesive backed Mylar ring
- 1 Metal plate ring
- 1 Torx T10 security L-Key
- 1 Printed Quick Start Guide
- 1 Printed hot surface Warning leaflet
- 1 Printed regulatory document
- 1 Guide pattern template for camera head
- 1 Guide pattern template for electronics box

2- Installation tools

- Drill
- Screw Drivers
- Wire Cutters

3- Quick Reference

- Default IP: 192.168.1.168
- Default Username: admin
- Default Password: admin
- Power: PoE 802.3af/802.3at Type 1 Class 3.
- Do not disconnect when power (PSE) is connected.

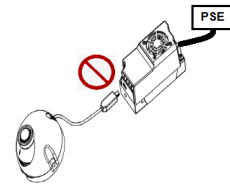

- Connections and Reset / Reboot to default

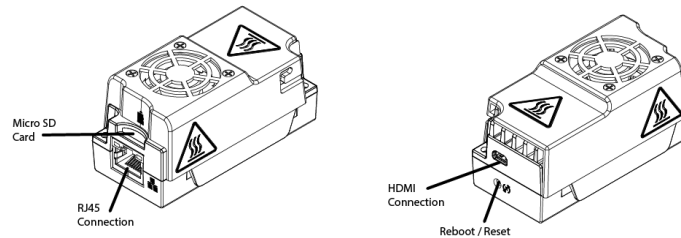

4- Electronic box Installation

- Secure the electronic control box to a surface using the 3mm x 25mm screws.

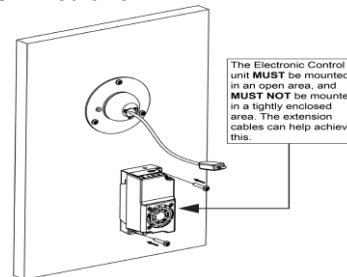

5- Surface Mount Installations (See Section 6 for Surface Mount Installations).

- Secure the eyeball to a surface using the 3mm x 10mm screws.



- Continue with Step # 7

6- Recessed Mount Installations (Behind the Wall)

- Use the torx T10 Security L-Key to remove the screw on the camera base and remove the dome cover.

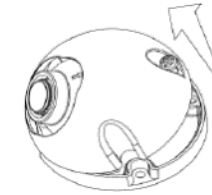

- Secure the eyeball

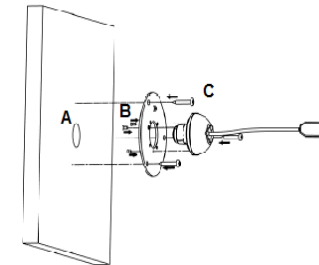

- A: Drill a hole (20mm diameter).
- B: Secure the eyeball to metal plate using (M2.5 x 0.45P x 4mm) screws.
- C: Securely attach the three (3mm x 10mm) screws on the 'ring' plate to the wall rear.

7- Recessed Mount Installations (Front)

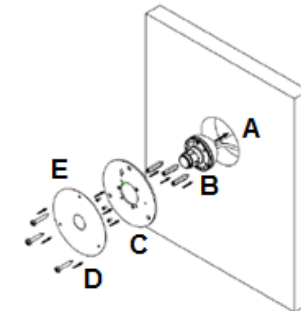

- A: Drill a hole (51mm diameter).
- B: Secure the standoff to the eyeball (3 Hex stand-offs M2.5 x 0.45P x 17mm).
- C: Secure eyeball to metal plate using (M2.5 x 0.45P x 4mm) screws.
- D: Secure the metal plate to the wall using 3mm x 10mm screws.
- E: Use deco adhesive to cover metal plate/screws.

8- Connect eyeball assembly to electronics control box

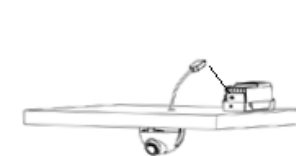

- Surface mount and power up the unit.

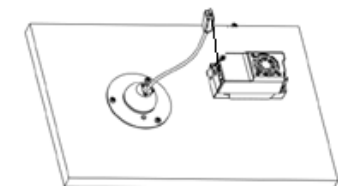

- Recessed mount