



Quick Reference Guide

Illustra Pro PTZ Indoor Housing Assembly

Notice

The information in this manual was current when published. The manufacturer reserves the right to revise and improve its products. All specifications are therefore subject to change without notice.

Copyright

Under copyright laws, the contents of this manual may not be copied, photocopied, reproduced, translated or reduced to any electronic medium or machine-readable form, in whole or in part, without prior written consent of Tyco Security Products © 2015 and its Respective Companies. All Rights Reserved.

Tyco Security Products
6600 Congress Avenue
Boca Raton, FL 33487 U.S.A.

Customer Service

Thank you for using Tyco Security Products. We support our products through an extensive worldwide network of dealers. The dealer through whom you originally purchased this product is your point of contact if you need service or support. Our dealers are empowered to provide the very best in customer service and support. Dealers should contact Tyco Security Products at (800) 507-6268 or (561) 912-6259 or on the Web at www.illustracameras.com.

Trademarks

The trademarks, logos, and service marks displayed on this document are registered in the United States [or other countries]. Any misuse of the trademarks is strictly prohibited and Tyco Security Products will aggressively enforce its intellectual property rights to the fullest extent of the law, including pursuit of criminal prosecution wherever necessary. All trademarks not owned by Tyco Security Products are the property of their respective owners, and are used with permission or allowed under applicable laws.

Product offerings and specifications are subject to change without notice. Actual products may vary from photos. Not all products include all features. Availability varies by region; contact your sales representative.

License Information

Your use of this product is governed by certain terms and conditions. Please see the detailed license information at the end of this manual.

Table of Contents

Illustra Pro PTZ Indoor Housing Assembly

To the Installer	1
What's in the box	1
Standard Items	1
Tools Required	1
Always use	1
Installing the Indoor Housing Assembly	2
Installing the Indoor Housing Assembly with the Safety Lanyard	2
Installing the Indoor Housing Assembly with the Thumb Screw	4
Replacing the Indoor Housing Assembly Filter Strips	6

Illustra Pro PTZ Indoor Housing Assembly

To the Installer

This guide assumes that an Illustra Pro PTZ dome has already been installed.

Note

- 1 The indoor housing assembly should only be installed on a dome that has been attached to an appropriate mount or installed on the surface.
 - 2 The indoor housing assembly should always be removed before attempting to remove the Illustra Pro PTZ Dome from the surface mounting base.
-

What's in the box

Standard Items

- Illustra Pro PTZ Indoor Housing Assembly
- M3 Thumb Screw
- White Lock Cap (only available with White Indoor Housing Assembly)
- Quick Reference Guide

Tools Required

- 2.5mm (0.1in) slotted screwdriver

Always use

- Proper safety equipment for the location and type of installation.
- Proper lift equipment to reach the installation.
- Safety features of the lift equipment.

Installing the Indoor Housing Assembly

There are two procedures which can be used to install the Illustra Pro PTZ Indoor Housing Assembly. Select which procedure is relevant to your installation requirements and follow the details provided.

- Installing the Indoor Housing Assembly with the Safety Lanyard
- Installing the Indoor Housing Assembly with the Thumb Screw

Note

- 1 It is not necessary to disconnect or power down the Illustra Pro PTZ dome before installing or removing the indoor housing assembly. Unless you are replacing the lock cap.
- 2 If using the ADCiM6WALLxK Wall Mount use the safety lanyard procedure for securing the indoor housing. The thumb screw method is not recommend for use with this wall mount.
- 3 If required, replace the original lock cap with the white lock cap supplied with the white version of the Indoor Housing Assembly.

Installing the Indoor Housing Assembly with the Safety Lanyard

Step	Action
------	--------

- | | |
|---|---|
| 1 | Remove the indoor housing assembly from the packaging and ensure that the bubble is clean and free from debris. |
| 2 | Attach the safety lanyard on the indoor housing assembly to the screw hole on the dome using the supplied M3 thumb screw as seen in Figure 1. |

Figure 1

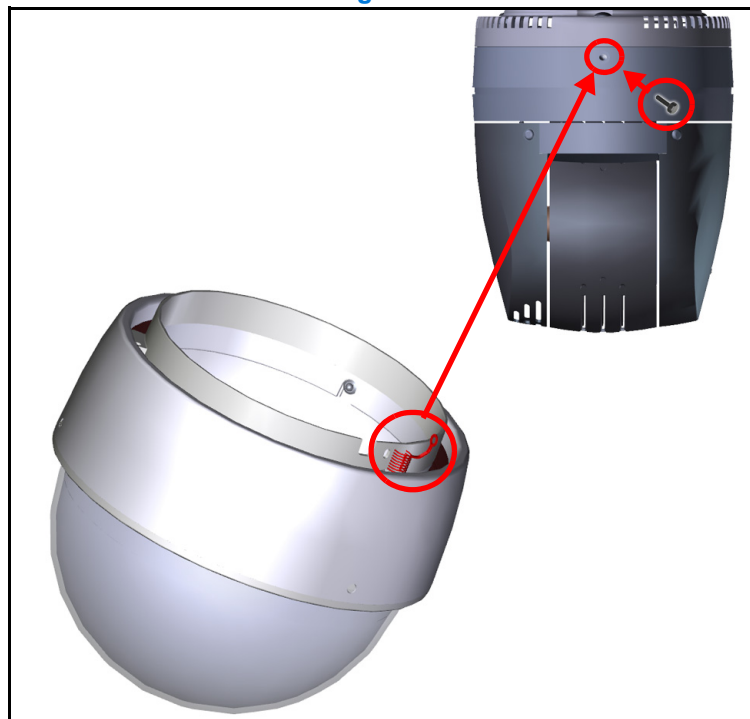

- 3 Align the indoor housing assembly with the dome as seen in Figure 2.
When aligning the indoor housing with the dome ensure that the cutout on the collar allows the safety lanyard screw to be accessed.

Figure 2

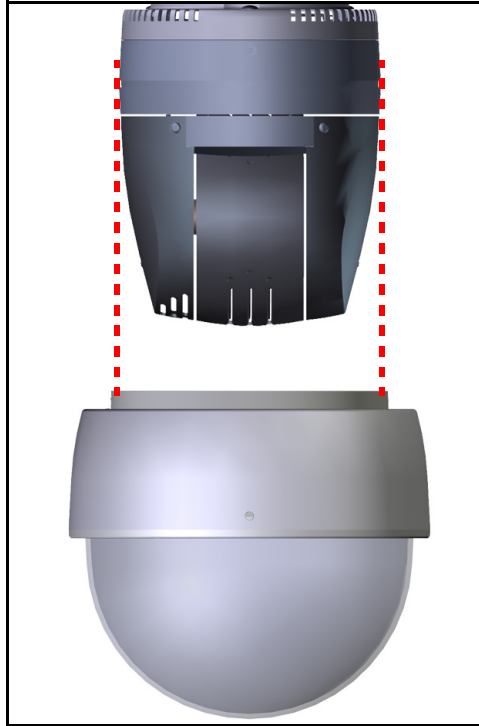

- 4 Maintaining upward pressure slide the indoor housing assembly over the dome to secure as seen in Figure 3. A positive click will be heard when the indoor housing assembly has fully engaged.



Ensure that the safety lanyard does not become trapped between the dome and the collar of the indoor housing assembly.

Figure 3



- 5 The indoor housing assembly is now secure.

Note

To remove the indoor housing assembly, rotate slightly and pull to release.

- 6 Remove the protective film from the bubble.

- End -

Installing the Indoor Housing Assembly with the Thumb Screw

Step	Action
------	--------

- 1 Remove the indoor housing assembly from the packaging and ensure that the bubble is clean and free from debris.
- 2 Remove the safety lanyard on the indoor housing assembly.
- 3 Align the indoor housing assembly with the dome ensuring that the screw hole cutout aligns with the screw hole on the side of the dome as seen in Figure 4.

Figure 4

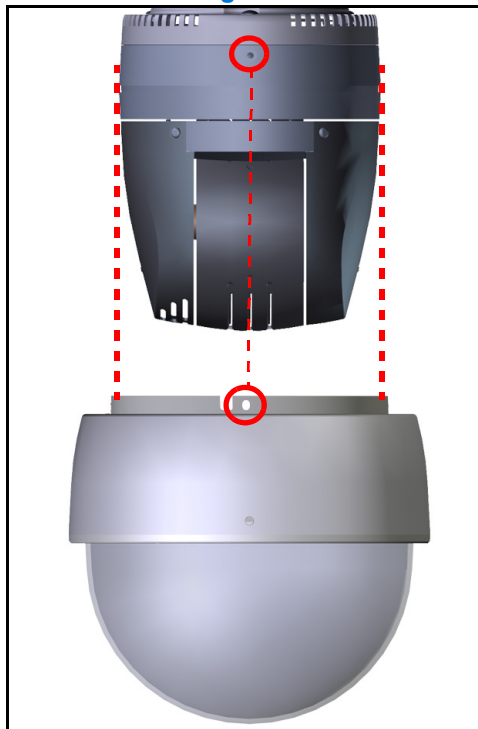

- 4 Maintaining upward pressure slide the indoor housing assembly over the dome to secure. A positive click will be heard when the indoor housing assembly has fully engaged.
- 5 The indoor housing assembly is now secure.
- 6 Insert the supplied M3 thumb screw through screw hole cutout and secure to the indoor housing assembly as seen in Figure 5.

Figure 5



Note

To remove the indoor housing assembly, remove the M3 thumb screw and rotate slightly and pull to release.

- 7 Remove the protective film from the bubble.
-

- End -

Replacing the Indoor Housing Assembly Filter Strips

Depending on the type of environment that the dome is operating in, it may be necessary at some stage to change the filter strips in the indoor housing assembly.

The Air Filter Strip Kit will be required to complete this procedure.

Contact your Tyco Security Products representative for further information.

Step	Action
------	--------

- 1 Remove the indoor housing assembly from the dome:
 - If using the safety lanyard, rotate the indoor housing assembly slightly and pull to release. Detach the safety lanyard by removing the M3 thumb screw on the dome.
 - Or
 - If using the tamper resistant bracket, remove the M3 thumb screw from the tamper resistant bracket, rotate the indoor housing assembly slightly and pull to release.
- 2 Remove all three filter strips from the trim ring housing as seen in Figure 6 and dispose of accordingly.

Figure 6

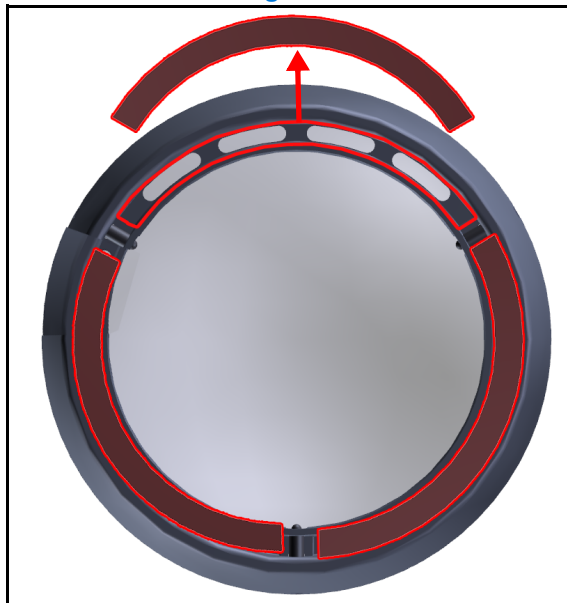

- 3 Remove the filter strip from the filter strip kit and separate into three strips by tearing along the perforated lines.
- 4 Insert the new filter strips one at a time by shaping each piece to the curve of the housing and pushing them into place in the trim ring housing.
- 5 Refer to Installing the Indoor Housing Assembly with the Safety Lanyard or Installing the Indoor Housing Assembly with the Thumb Screw for details on reinstalling the indoor housing assembly.

- End -
